

# DACRES ROAD, LONDON, SE23

- DEEPDENE POINT DC/23/130571
- CLAIRVILLE POINT DC/23/130561
- ROSEMOUNT POINT DC/23/130570
- ASHLEIGH POINT DC/23/130573
- HEATHWOOD POINT DC/23/130574

**Refurbishment of external cladding, replacement of windows, doors, balconies, screens and roof finishes**

This presentation forms no part of a planning application  
and is for information only.

# Site Location Plan

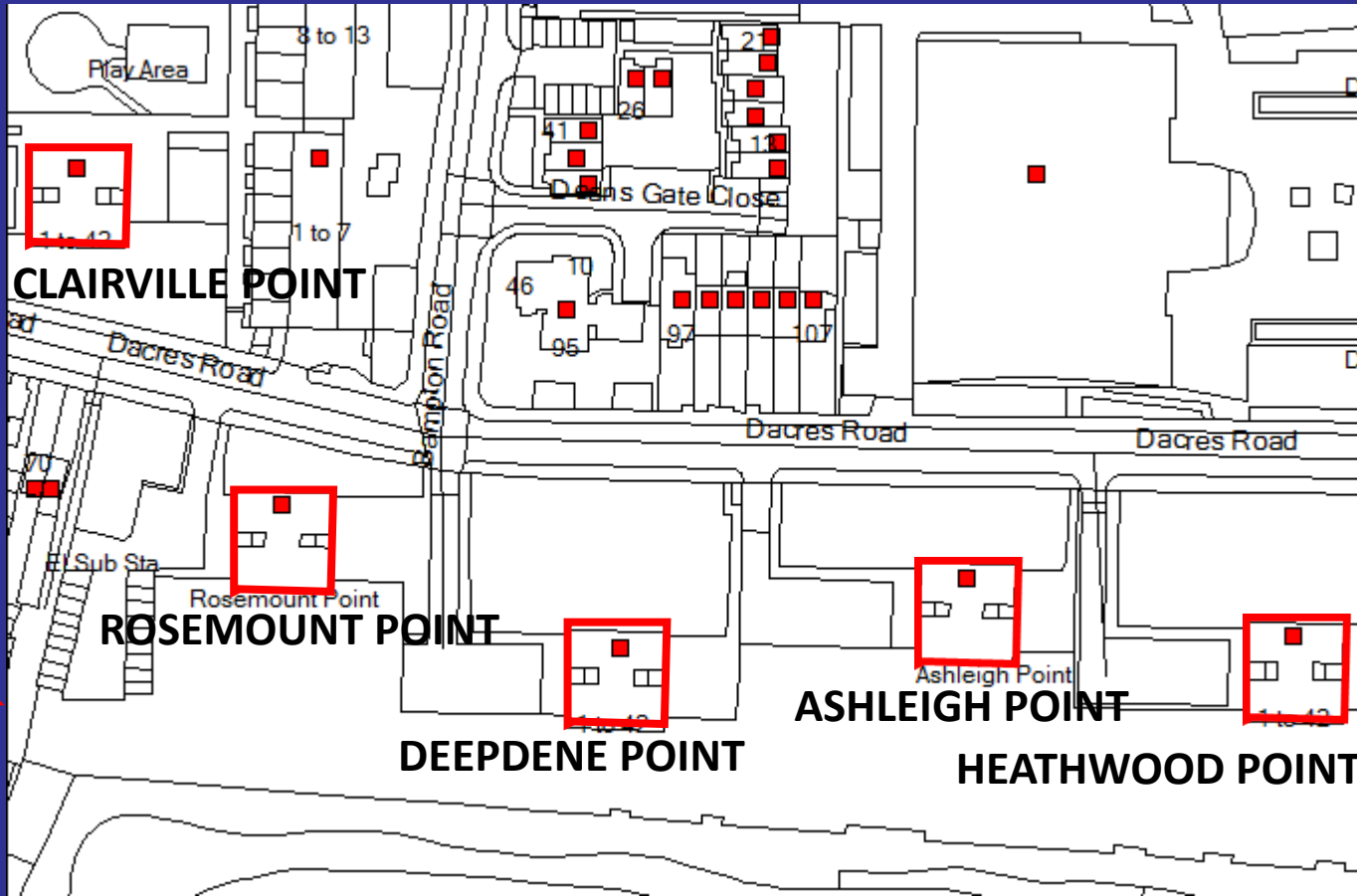

# Site Location Arial- Context





# Existing and proposed South West and North East



EXISTING SOUTH WEST



PROPOSED SOUTH WEST



EXISTING NORTH EAST



PROPOSED NORTH EAST

# Existing and Proposed South East and North West



EXISTING SOUTH EAST



PROPOSED SOUTH EAST



EXISTING NORTH WEST



PROPOSED NORTH WEST

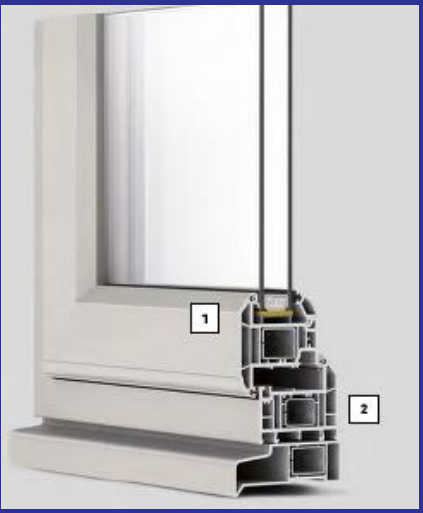
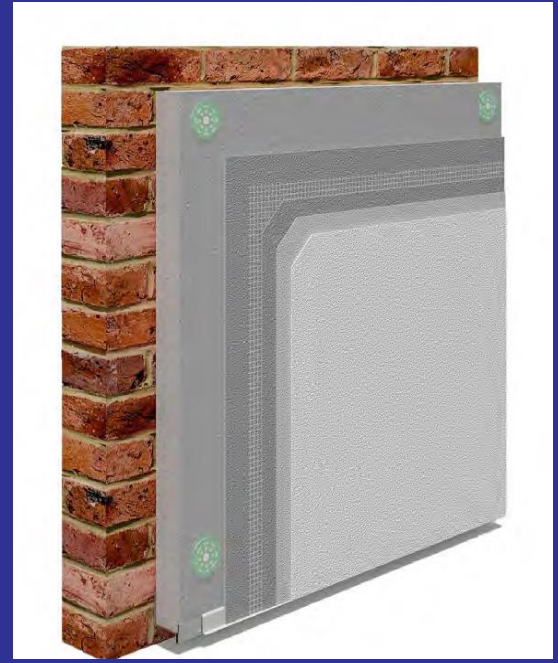
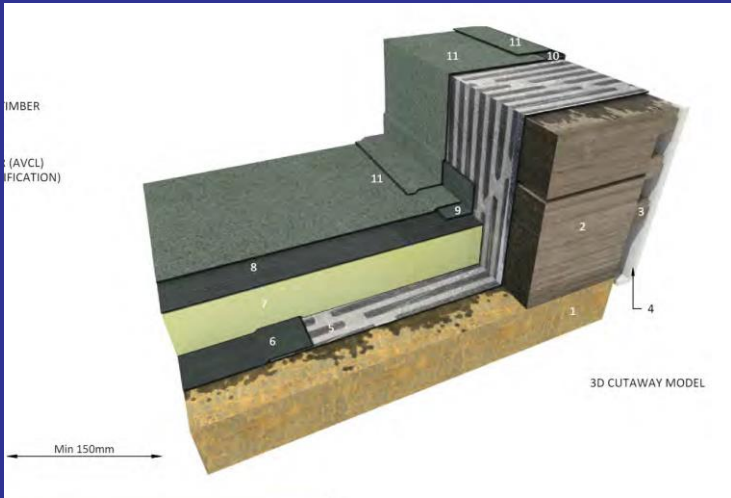

# Existing and proposed Balustrades Top Floor



# Existing and proposed Balustrades Ground Floor



# Key Planning Considerations

- Principle of Development
- Urban Design
- Impact on Adjoining Properties
- Highway and Transportation
- Sustainable Development



End